

THIS DOCUMENT AND ATTACHMENT(S) ARE AVAILABLE FOR DOWNLOAD AT  
[http://www.bxwa.com/bxwa\\_toc/pub/1687/toc.html](http://www.bxwa.com/bxwa_toc/pub/1687/toc.html)  
AN EMAIL NOTIFICATION WAS SENT TO REGISTERED PLANHOLDERS. FAILURE TO  
ACKNOWLEDGE RECEIPT ON THE BID FORM DOES NOT AFFECT THE BIDDER'S  
OBLIGATION FOR COMPLIANCE.

## ADDENDUM NO. 2

### SAINT EDWARD STATE PARK ENVIRONMENTAL EDUCATION AND RESEARCH CENTER NW-C4008

DATE: January 25, 2021

ATTENTION TO PLANHOLDERS OF RECORD is called to the following revisions of the contract documents:

**I. Specifications:**

SECTION 122413 - EXTERIOR ROLLER WINDOW SHADE - ADD ALTERNATE #4

Remove 2.1.A. Manufacture, and REPLACE with:

PART 2 - PRODUCTS

2.1 EXTERIOR ROLLER SHADES (ADDITIVE ALTERNATE #4)

A. Manufacturer:

1. Rainier Series 4 Square Profile Exterior roll-down sunshade
2. Or Equal product by Corradi is acceptable.

SECTION 211300 - FIRE-SUPPRESSION SPRINKLER SYSTEMS

Existing panel is a Notifier AFP-200 fire alarm control panel as indicated by the picture in Addendum 2 – Attachment A Fire Alarm Control Panel.

**II. Project Drawings:**

Add Sketch SK001 to show landscaping that will be removed by owner in advance of work.

Michael MAVERICK

  
\_\_\_\_\_  
Manuel Iglesias, Contracts Specialist 2 - MANAGER  
Contracts, Grants, and Procurement Services

1/26/2021  
\_\_\_\_\_  
Date

END OF ADDENDUM NO. 1

Attachments: Addendum 2 – Attachment A  
Addendum 2 – Attachment B

ADDENDUM 2 – ATTACHMENT A  
EXISTING FIRE ALARM CONTROL PANEL



**ADDENDUM 2 – ATTACHMENT 2  
SKETCH**

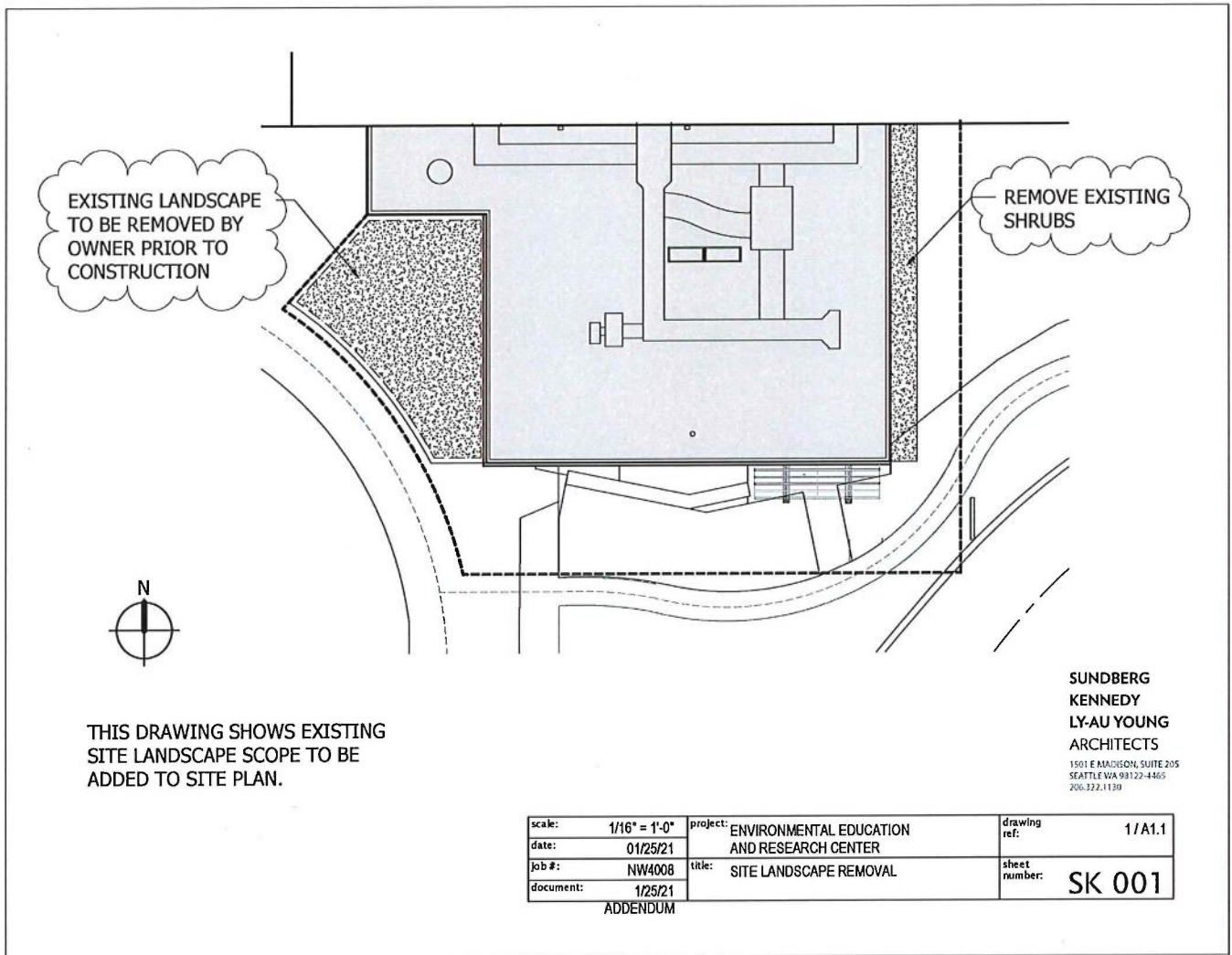

THIS DRAWING SHOWS EXISTING  
SITE LANDSCAPE SCOPE TO BE  
ADDED TO SITE PLAN.

**SUNDBERG  
KENNEDY  
LY-AU YOUNG  
ARCHITECTS**  
1501 E MADISON, SUITE 205  
SEATTLE WA 98122-4465  
206.322.1139

scale:	1/16" = 1'-0"	project:	ENVIRONMENTAL EDUCATION AND RESEARCH CENTER	drawing ref:	1/A1.1
date:	01/25/21	job #:	NW4008	sheet number:	SK 001
document:	1/25/21	title:	SITE LANDSCAPE REMOVAL		

ADDENDUM